

# CHEMSTEEL

## Chemsteel S(M)203, S(M)204, S(M)205, S(M)207, S(M)210 & S(M)214 Ryton

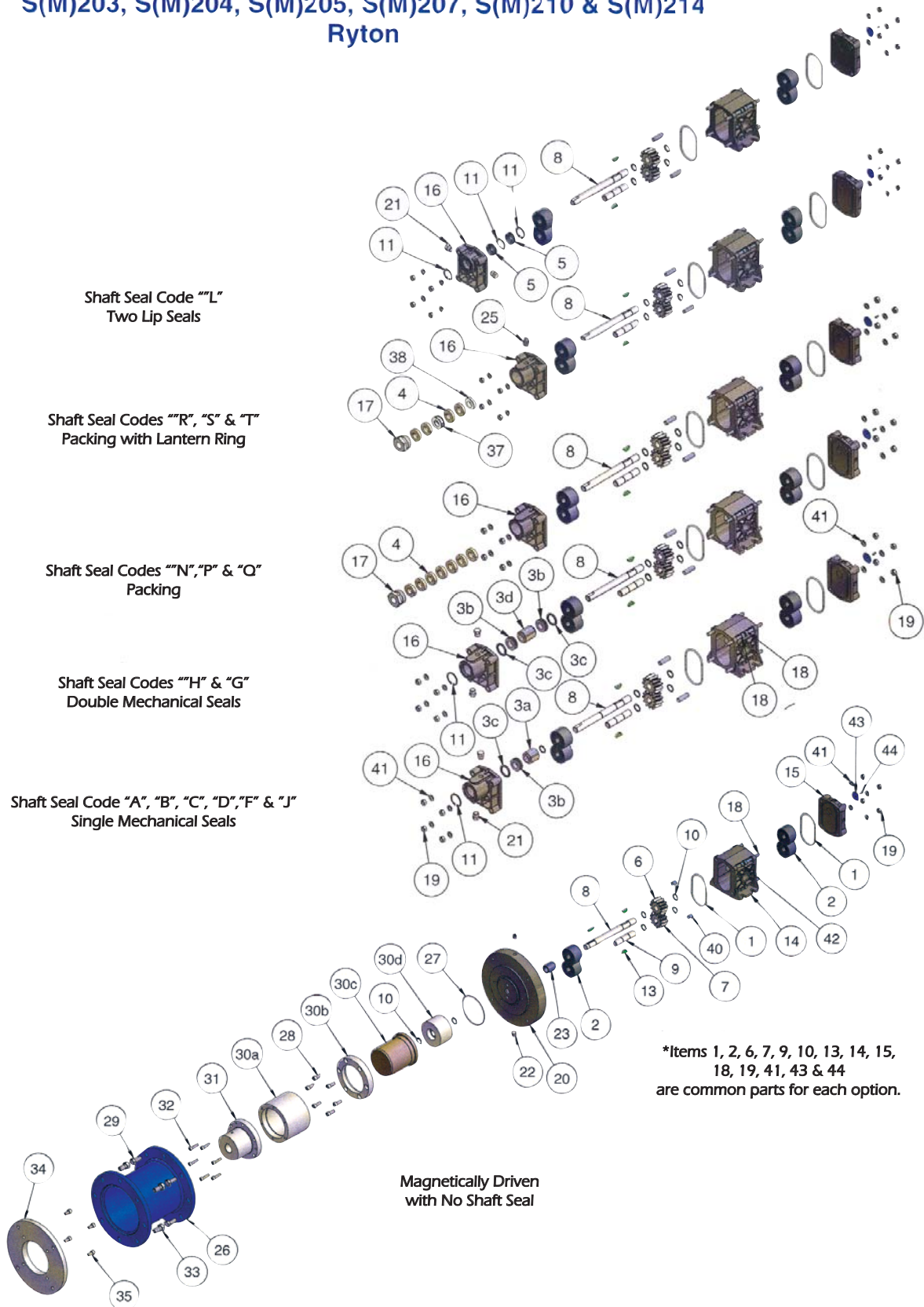

Shaft Seal Code "L"  
Two Lip Seals

Shaft Seal Codes "R", "S" & "T"  
Packing with Lantern Ring

Shaft Seal Codes "N", "P" & "O"  
Packing

Shaft Seal Codes "H" & "G"  
Double Mechanical Seals

Shaft Seal Code "A", "B", "C", "D", "F" & "J"  
Single Mechanical Seals

Magnetically Driven  
with No Shaft Seal

\*Items 1, 2, 6, 7, 9, 10, 13, 14, 15,  
18, 19, 41, 43 & 44  
are common parts for each option.